

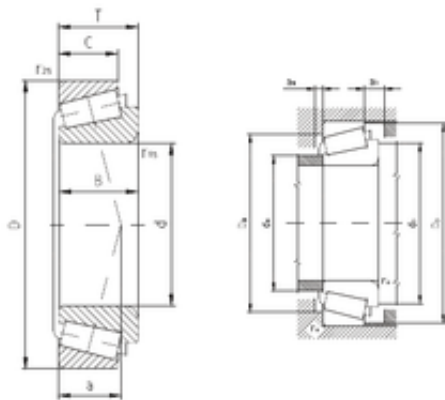

LAD Bearing International Trade Co., ...

ZVL 30232A tapered roller bearings



Bearing No. 30232A

Size	160x290x52 mm
Bore Diameter	160 mm
Outer Diameter	290 mm
Width	52 mm
d	160 mm
D	290 mm
T	52 mm
B	48 mm
C	40 mm
a	51 mm
r1 min.	4 mm
r2 min.	3 mm
da max	189 mm
Da min	252 mm
Da max.	276 mm
db min	174 mm
Db min.	269 mm
ra max.	3 mm
Weight	13,8 Kg
Basic dynamic load rating (C)	511 kN
Basic static load rating (C0)	695 kN
(Grease) Lubrication Speed	1 200 r/min
(Oil) Lubrication Speed	1 700 r/min
Calculation factor (e)	0,37
Calculation factor (Y)	1,6

30232A Bearing 2D drawings and 3D CAD models