

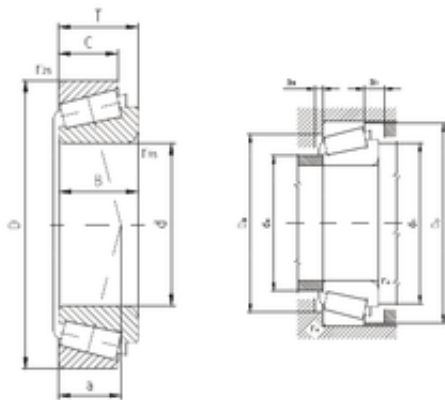

LAD Bearing International Trade Co., ...

ZVL 32310A tapered roller bearings



Bearing No. 32310A

Size	50x110x42.25 mm
Bore Diameter	50 mm
Outer Diameter	110 mm
Width	42,25 mm
d	50 mm
D	110 mm
T	42,25 mm
B	40 mm
C	33 mm
a	27 mm
r1 min.	2,5 mm
r2 min.	2 mm
da max	62 mm
Da min	94 mm
Da max.	100 mm
db min	60 mm
Db min.	102 mm
ra max.	2 mm
Weight	2,01 Kg
Basic dynamic load rating (C)	178 kN
Basic static load rating (C0)	224 kN
(Grease) Lubrication Speed	3 300 r/min
(Oil) Lubrication Speed	4 500 r/min
Calculation factor (e)	0,35
Calculation factor (Y)	1,7

32310A Bearing 2D drawings and 3D CAD models