

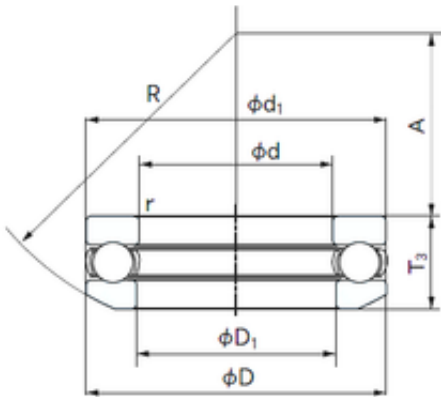

LAD Bearing International Trade Co., ...

NACHI 53272 thrust ball bearings

Bearing No. 53272



53272 Bearing 2D drawings and 3D CAD models

Size	360x500x116.7 mm
Bore Diameter	360 mm
Outer Diameter	500 mm
Width	116.7 mm
d	360 mm
D	500 mm
T	116.7 mm
d1	495 mm
r min.	4 mm
A	172 mm
D1	365 mm
R	360 mm
Weight	67.7 Kg
Basic dynamic load rating (C)	745 kN
Basic static load rating (C0)	3800 kN
(Grease) Lubrication Speed	380 r/min